



## SOD-323 Plastic-Encapsulate Diodes

### ZESD3V3D3 Uni-direction ESD Protection Diode

#### DESCRIPTION

Designed to protect voltage sensitive electronic components from ESD and other transients. Excellent clamping capability, low leakage, and fast response time provide best in class protection on designs that are exposed to ESD.

The combination of small size, high level of ESD protection makes them a flexible solution for applications such as HDMI, Display Port TM, and MDDI interfaces. It is designed to replace multiplayer varistors (MLV) in consumer equipments applications such as mobile phone, notebook, PAD, STB, LCD TV etc.

#### SOD-323

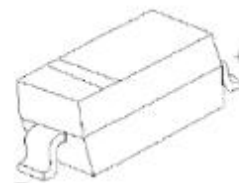

#### FEATURES

- Uni-directional ESD protection of one line
- Reverse stand-off voltage: 3.3V
- Low reverse clamping voltage
- Low leakage current
- Excellent package: 1.70mm × 1.30mm × 1.00mm
- Fast response time
- JESD22-A114-B ESD Rating of class 3B per human body model
- IEC 61000-4-2 Level 4 ESD protection

#### APPLICATIONS

- Computers and peripherals
- Audio and video equipment
- Cellular handsets and accessories
- Portable electronics
- Other electronics equipments communication systems

#### MARKING

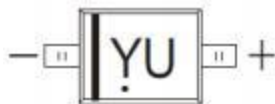

Front side

- YU = Device code
- Solid dot = Green molding compound device
- The marking bar indicates the cathode

**MAXIMUM RATINGS (  $T_a=25^{\circ}\text{C}$  unless otherwise noted )**

| Parameter  | Symbol               | Limit      | Unit               |
|--|----------------------|------------|--------------------|
| IEC 61000-4-2 ESD Voltage                              | Air Model            | $\pm 25$   | kV                 |
|  | Contact Model        | $\pm 25$   |                    |
| JESD22-A114-B ESD Voltage                              | Per Human Body Model | $\pm 16$   |                    |
| ESD Voltage  | Machine Model        | $\pm 0.4$  |                    |
| Peak Pulse Power                                       | $P_{PP}^{(2)}$       | 210        | W                  |
| Peak Pulse Current                                     | $I_{PP}^{(2)}$       | 16         | A                  |
| Lead Solder Temperature – Maximum (10 Second Duration) | $T_L$                | 260        | $^{\circ}\text{C}$ |
| Operation Junction and Storage Temperature Range       | $T_J, T_{stg}$       | -55 ~ +150 | $^{\circ}\text{C}$ |

(1).Device stressed with ten non-repetitive ESD pulses.

(2).Non-repetitive current pulse 8/20 $\mu\text{s}$  exponential decay waveform according to IEC61000-4-5.

**ESD standards compliance**

**IEC61000-4-2 Standard**

| Contact Discharge |                 | Air Discharge |                 |
|-------------------|-----------------|---------------|-----------------|
| Level             | Test Voltage kV | Level         | Test Voltage kV |
| 1                 | 2               | 1             | 2               |
| 2                 | 4               | 2             | 4               |
| 3                 | 6               | 3             | 8               |
| 4                 | 8               | 4             | 15              |

**JESD22-A114-B Standard**

| ESD Class | Human Body Discharge V |
|-----------|------------------------|
| 0         | 0~249                  |
| 1A        | 250~499                |
| 1B        | 500~999                |
| 1C        | 1000~1999              |
| 2         | 2000~3999              |
| 3A        | 4000~7999              |
| 3B        | 8000~15999             |

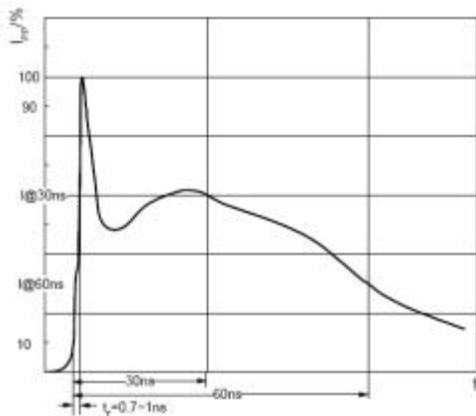

ESD pulse waveform according to IEC61000-4-2

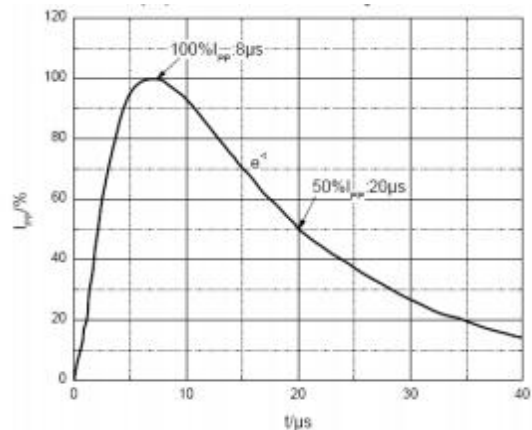

8/20 $\mu\text{s}$  pulse waveform according to IEC 61000-4-5

**ELECTRICAL PARAMETER**

| Symbol    | Parameter                           |
|-----------|-------------------------------------|
| $V_C$     | Clamping Voltage @ $I_{PP}$         |
| $I_{PP}$  | Peak Pulse Current                  |
| $V_{BR}$  | Breakdown Voltage @ $I_T$           |
| $I_T$     | Test Current                        |
| $I_R$     | Reverse Leakage Current @ $V_{RWM}$ |
| $V_{RWM}$ | Reverse Standoff Voltage            |
| $V_F$     | Forward Voltage@ $I_F$              |
| $I_F$     | Forward Current                     |

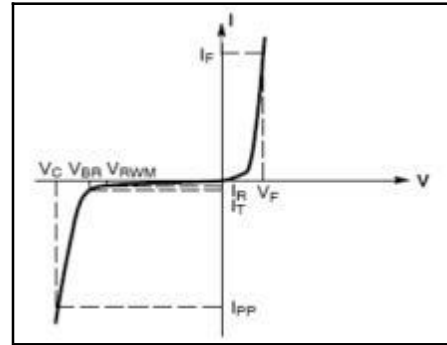

V-I characteristics for a uni-directional TVS

**ELECTRICAL CHARACTERISTICS( $T_a=25^{\circ}C$  unless otherwise specified)**

| Parameter                | Symbol          | Test conditions  | Min | Typ | Max | Unit    |
|--------------------------|-----------------|------------------|-----|-----|-----|---------|
| Reverse standoff voltage | $V_{RWM}^{(1)}$ |                  |     |     | 3.3 | V       |
| Reverse leakage current  | $I_R$           | $V_{RWM}=3.3V$   |     |     | 10  | $\mu A$ |
| Breakdown voltage        | $V_{(BR)}$      | $I_T=1mA$        | 5.0 |     | 5.9 | V       |
| Clamping voltage         | $V_C^{(2)}$     | $I_{PP}=16A$     |     |     | 13  | V       |
| Forward voltage          | $V_F$           | $I_F=10mA$       |     |     | 0.9 | V       |
| Junction capacitance     | $C_J$           | $V_R=0V, f=1MHz$ |     | 120 |     | pF      |

(1).Other voltages available upon request.

(2).Non-repetitive current pulse 8/20 $\mu s$  exponential decay waveform according to IEC61000-4-5

TYPICAL CHARACTERISTICS

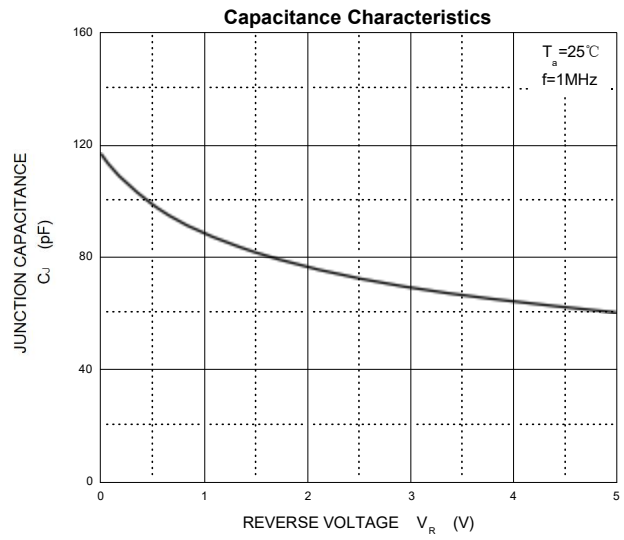
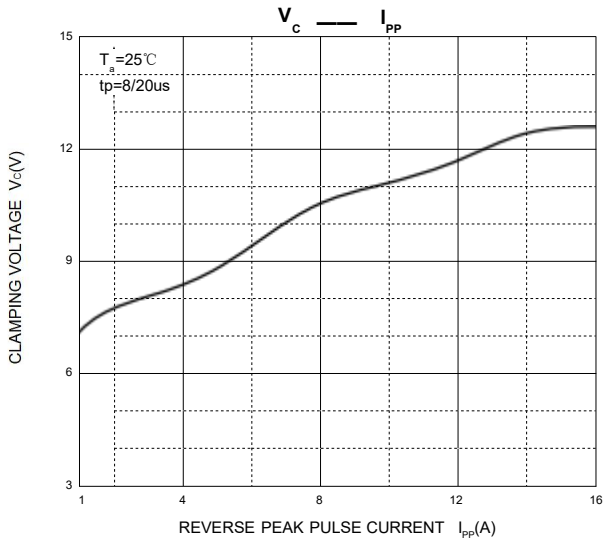
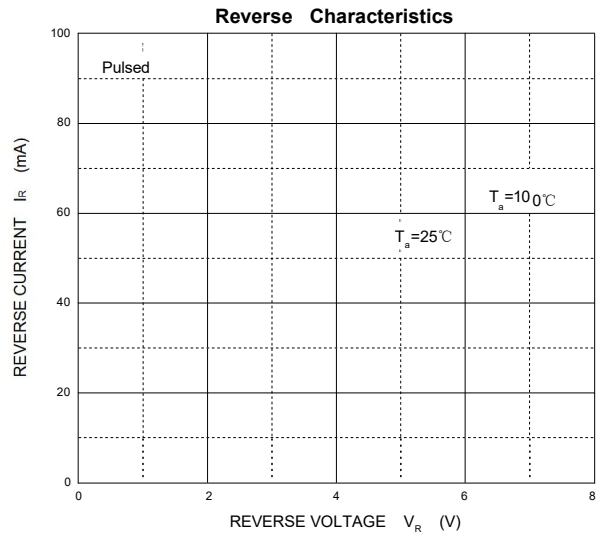
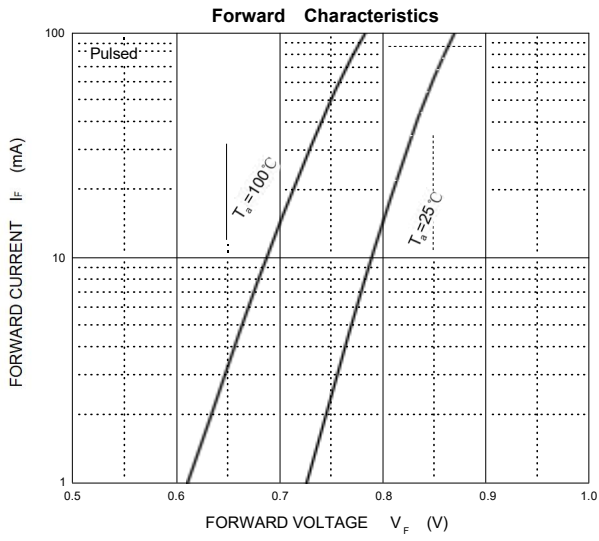

SOD-323 Package Outline Dimensions

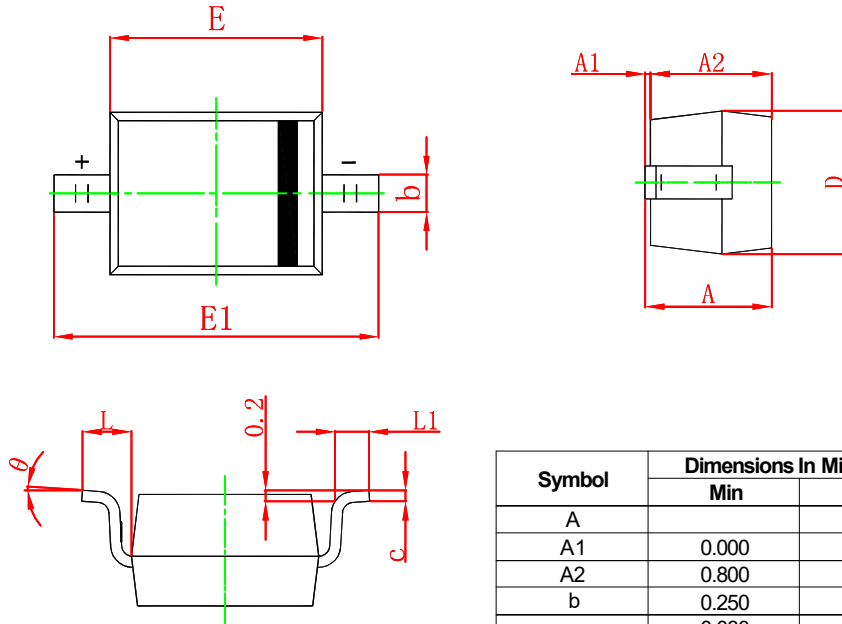

| Symbol | Dimensions In Millimeters |       |           |       |
|--------|---------------------------|-------|-----------|-------|
|        | Min                       | Max   | Min       | Max   |
| A      |                           | 1.100 |           | 0.043 |
| A1     | 0.000                     | 0.100 | 0.000     | 0.004 |
| A2     | 0.800                     | 1.000 | 0.031     | 0.039 |
| b      | 0.250                     | 0.350 | 0.010     | 0.014 |
| c      | 0.080                     | 0.150 | 0.003     | 0.006 |
| D      | 1.200                     | 1.400 | 0.047     | 0.055 |
| E      | 1.600                     | 1.800 | 0.063     | 0.071 |
| E1     | 2.500                     | 2.750 | 0.098     | 0.108 |
| L      | 0.475 REF                 |       | 0.019 REF |       |
| L1     | 0.250                     | 0.400 | 0.010     | 0.016 |
| θ      | 0°                        | 8°    | 0°        | 8°    |

SOD-323 Suggested Pad Layout

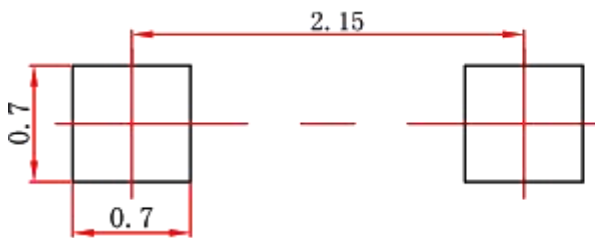

- Note:**
1. Controlling dimension: in millimeters.
  2. General tolerance:  $\pm 0.05\text{mm}$ .
  3. The pad layout is for reference purposes only.

**TAPE AND REEL INFORMATION**

**SOD-323 Embossed Carrier Tape**

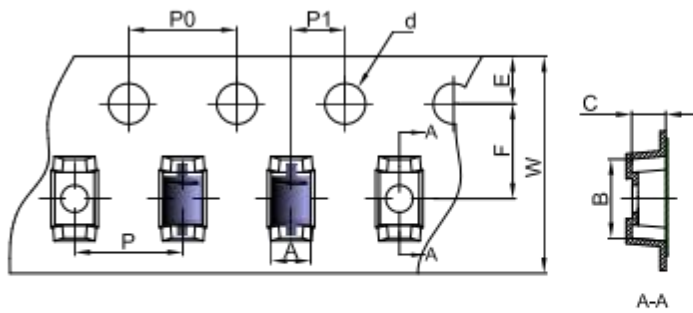

**Packaging Description:**

SOD-323 parts are shipped in tape. The carrier tape is made from a dissipative (carbon filled) polycarbonate resin. The cover tape is a multilayer film (Heat Activated Adhesive in nature) primarily composed of polyester film, adhesive layer, sealant, and anti-static sprayed agent. These reeled parts in standard option are shipped with 3,000 units per 7" or 17.8cm diameter reel. The reels are clear in color and is made of polystyrene plastic (anti-static coated).

| Dimensions are in millimeter |      |     |      |       |      |      |      |      |      |      |
|------------------------------|------|-----|------|-------|------|------|------|------|------|------|
| Pkg type                     | A    | B   | C    | d     | E    | F    | P0   | P    | P1   | W    |
| SOD-323                      | 1.48 | 3.3 | 1.25 | Ø1.50 | 1.75 | 3.50 | 4.00 | 4.00 | 2.00 | 8.00 |

**SOD-323 Tape Leader and Trailer**

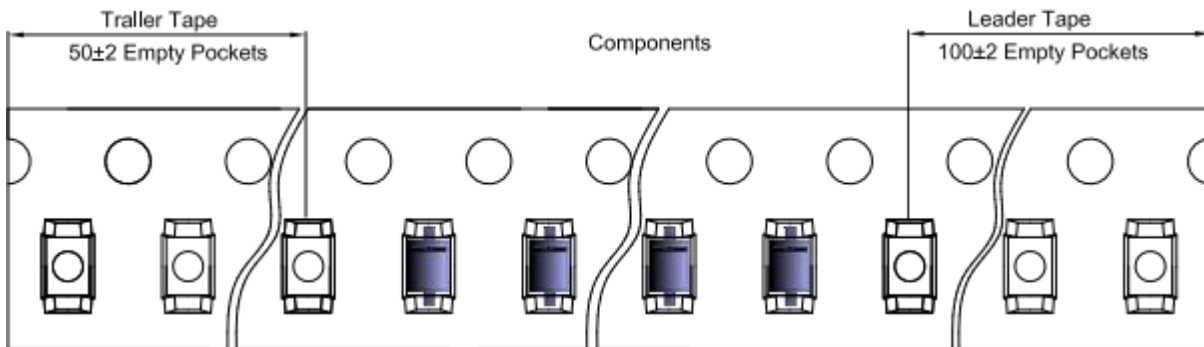

**SOD-323 Reel**

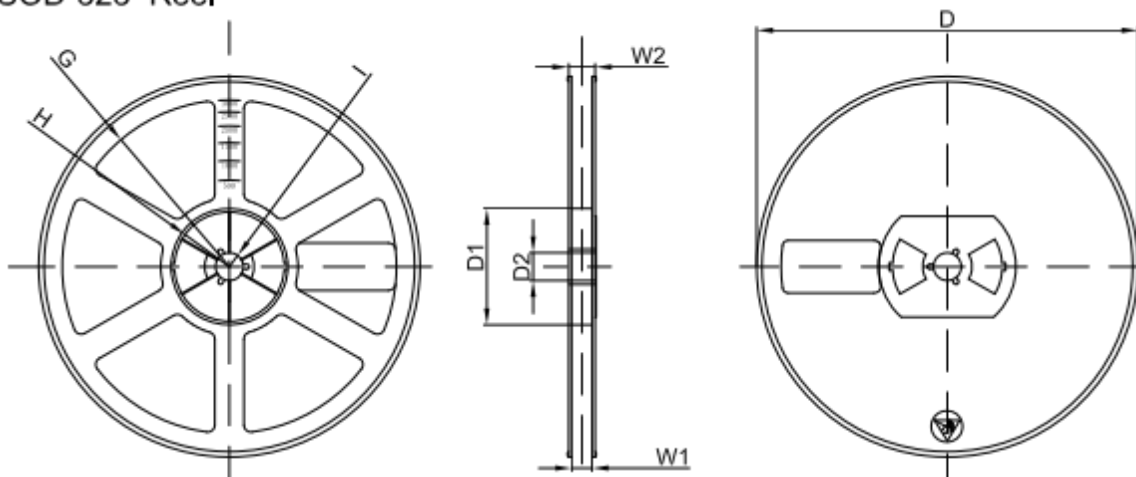

| Dimensions are in millimeter |         |       |       |        |        |       |      |       |
|------------------------------|---------|-------|-------|--------|--------|-------|------|-------|
| Reel Option                  | D       | D1    | D2    | G      | H      | I     | W1   | W2    |
| 7" Dia                       | Ø178.00 | 54.40 | 13.00 | R78.00 | R25.60 | R6.50 | 9.50 | 12.30 |

| REEL     | Reel Size | Box        | Box Size(mm) | Carton      | Carton Size(mm) | G.W.(kg) |
|----------|-----------|------------|--------------|-------------|-----------------|----------|
| 3000 pcs | 7 Inch    | 45,000 pcs | 203×203×195  | 180,000 pcs | 438×438×220     |          |